

HA-48

## Clark's Chapel M.E. Church

### **Architectural Survey File**

This is the architectural survey file for this MIHP record. The survey file is organized reverse-chronological (that is, with the latest material on top). It contains all MIHP inventory forms, National Register nomination forms, determinations of eligibility (DOE) forms, and accompanying documentation such as photographs and maps.

Users should be aware that additional undigitized material about this property may be found in on-site architectural reports, copies of HABS/HAER or other documentation, drawings, and the “vertical files” at the MHT Library in Crownsville. The vertical files may include newspaper clippings, field notes, draft versions of forms and architectural reports, photographs, maps, and drawings. Researchers who need a thorough understanding of this property should plan to visit the MHT Library as part of their research project; look at the MHT web site ([mht.maryland.gov](http://mht.maryland.gov)) for details about how to make an appointment.

All material is property of the Maryland Historical Trust.

***Last Updated: 02-18-2004***

HA-48

Clark's Chapel M.E. Church  
2001 Kalmia Road  
Bel Air vicinity  
Semi-public

1885;1972

Clark's Chapel Methodist Episcopal Church is the most recent building on the site of a Black church which pre-dated the Civil War. The 1858 Jennings and Herrick map shows simply that a church existed here; the 1878 Hartenett map identifies it as a "colored church." The present structure probably replaced the earlier building.

## INVENTORY FORM FOR STATE HISTORIC SITES SURVEY

**1 NAME**

HISTORIC Clark's Chapel Methodist Episcopal Church

AND/OR COMMON Clark's United Methodist Church

**2 LOCATION**STREET & NUMBER  
2001 Kalmia RoadCITY, TOWN  
Bel Air☒ VICINITY OFCONGRESSIONAL DISTRICT  
2ndSTATE  
MarylandCOUNTY  
Harford**3 CLASSIFICATION**

CATEGORY	OWNERSHIP	STATUS	PRESENT USE
<input type="checkbox"/> DISTRICT	<input checked="" type="checkbox"/> PUBLIC	<input checked="" type="checkbox"/> OCCUPIED	<input type="checkbox"/> AGRICULTURE <input type="checkbox"/> MUSEUM
<input checked="" type="checkbox"/> BUILDING(S)	<input type="checkbox"/> PRIVATE	<input type="checkbox"/> UNOCCUPIED	<input type="checkbox"/> COMMERCIAL <input type="checkbox"/> PARK
<input type="checkbox"/> STRUCTURE	<input type="checkbox"/> BOTH	<input type="checkbox"/> WORK IN PROGRESS	<input type="checkbox"/> EDUCATIONAL <input type="checkbox"/> PRIVATE RESIDENCE
<input type="checkbox"/> SITE	<b>PUBLIC ACQUISITION</b>	<b>ACCESSIBLE</b>	<input type="checkbox"/> ENTERTAINMENT <input checked="" type="checkbox"/> RELIGIOUS
<input type="checkbox"/> OBJECT	<input type="checkbox"/> IN PROCESS	<input type="checkbox"/> YES, RESTRICTED	<input type="checkbox"/> GOVERNMENT <input type="checkbox"/> SCIENTIFIC
	<input type="checkbox"/> BEING CONSIDERED	<input checked="" type="checkbox"/> YES, UNRESTRICTED	<input type="checkbox"/> INDUSTRIAL <input type="checkbox"/> TRANSPORTATION
	Not applicable	<input type="checkbox"/> NO	<input type="checkbox"/> MILITARY <input type="checkbox"/> OTHER

**4 OWNER OF PROPERTY**

NAME Trustees of Clark's United Methodist Church Telephone #:

STREET & NUMBER  
2001 Kalmia RoadCITY, TOWN  
Bel Air☒ VICINITY OFSTATE, zip code  
MD 21014**5 LOCATION OF LEGAL DESCRIPTION**COURTHOUSE  
REGISTRY OF DEEDS, ETC. Harford County CourthouseSTREET & NUMBER  
40 South Main StreetCITY, TOWN  
Bel AirSTATE  
MD

Liber #:

Folio #:

**6 REPRESENTATION IN EXISTING SURVEYS**TITLE  
Maryland Historical Trust Historic Sites InventoryDATE  
c. 1970 ☐ FEDERAL ☒ STATE ☐ COUNTY ☐ LOCALDEPOSITORY FOR  
SURVEY RECORDS Maryland Historical TrustCITY, TOWN  
AnnapolisSTATE  
MD

## 7 DESCRIPTION

H-98

**CONDITION**

☐ EXCELLENT  
☒ GOOD  
☐ FAIR

☐ DETERIORATED  
☐ RUINS  
☐ UNEXPOSED

**CHECK ONE**

☐ UNALTERED  
☒ ALTERED

**CHECK ONE**

☒ ORIGINAL SITE  
☐ MOVED DATE \_\_\_\_\_

---

**DESCRIBE THE PRESENT AND ORIGINAL (IF KNOWN) PHYSICAL APPEARANCE**

Clark's United Methodist Church is a simple gable roofed stucco over stone church built in 1885 with additions in 1972 which is located on the northeast side of Kalmia Road southeast of the village of Kalmia in Harford County, Maryland. The church faces southwest and its cemetery is directly northwest of the building.

The main sanctuary of the church has two bays across the gable end and three bays on the sides. The south entrance foyer projects from the gable end and has new double doors, concrete porch and a wheelchair ramp. The entire foyer appears to be a 20th century addition. The windows in the side bays have simple wood frames with pointed arches. A stone in the southeast corner gives the date "1885". At the rear of the church is a one story addition, also stucco, in which a cornerstone reads "Renovated and education building built 1972, James Smith, pastor."

The cemetery contains several old weathered headstones with unreadable inscriptions and many 20th century markers. The oldest readable stone observed in the current survey is that of Milky Gover, died 1886 at age 77.

CONTINUE ON SEPARATE SHEET IF NECESSARY

PERIOD		AREAS OF SIGNIFICANCE -- CHECK AND JUSTIFY BELOW				
PREHISTORIC	<input type="checkbox"/> ARCHEOLOGY-PREHISTORIC	<input type="checkbox"/> COMMUNITY PLANNING	<input type="checkbox"/> LANDSCAPE ARCHITECTURE	<input type="checkbox"/> RELIGION		
<input type="checkbox"/> 1400-1499	<input type="checkbox"/> ARCHEOLOGY-HISTORIC	<input type="checkbox"/> CONSERVATION	<input type="checkbox"/> LAW	<input type="checkbox"/> SCIENCE		
<input type="checkbox"/> 1500-1599	<input type="checkbox"/> AGRICULTURE	<input type="checkbox"/> ECONOMICS	<input type="checkbox"/> LITERATURE	<input type="checkbox"/> SCULPTURE		
<input type="checkbox"/> 1600-1699	<input type="checkbox"/> ARCHITECTURE	<input type="checkbox"/> EDUCATION	<input type="checkbox"/> MILITARY	<input type="checkbox"/> SOCIAL/HUMANITARIAN		
<input type="checkbox"/> 1700-1799	<input type="checkbox"/> ART	<input type="checkbox"/> ENGINEERING	<input type="checkbox"/> MUSIC	<input type="checkbox"/> THEATER		
<input checked="" type="checkbox"/> 1800-1899	<input type="checkbox"/> COMMERCE	<input type="checkbox"/> EXPLORATION/SETTLEMENT	<input type="checkbox"/> PHILOSOPHY	<input type="checkbox"/> TRANSPORTATION		
<input type="checkbox"/> 1900-	<input type="checkbox"/> COMMUNICATIONS	<input type="checkbox"/> INDUSTRY	<input type="checkbox"/> POLITICS/GOVERNMENT	<input checked="" type="checkbox"/> OTHER (SPECIFY)	Black History	
		<input type="checkbox"/> INVENTION				

SPECIFIC DATES      1885; 1972

BUILDER/ARCHITECT

**STATEMENT OF SIGNIFICANCE**

Clark's Chapel Methodist Episcopal Church is the most recent building on the site of a Black church which pre-dated the Civil War. The 1858 Jennings and Herrick map shows simply that a church existed here; the 1878 Martenet map identifies it as a "colored church." The present structure probably replaced the earlier building.

CONTINUE ON SEPARATE SHEET IF NECESSARY

NA-13

**9 MAJOR BIBLIOGRAPHICAL REFERENCES**

CONTINUE ON SEPARATE SHEET IF NECESSARY

**10 GEOGRAPHICAL DATA**

ACREAGE OF NOMINATED PROPERTY \_\_\_\_\_

VERBAL BOUNDARY DESCRIPTION

LIST ALL STATES AND COUNTIES FOR PROPERTIES OVERLAPPING STATE OR COUNTY BOUNDARIES

STATE

COUNTY

STATE

COUNTY

**11 FORM PREPARED BY**

NAME / TITLE

Janet L. Davis, Historic Sites Surveyor

ORGANIZATION

Harford County Department of Planning & Zoning

DATE

October 1982

STREET & NUMBER

45 South Main Street

TELEPHONE

(301) 833-0000, Ext. 207

CITY OR TOWN

Bel Air

STATE

MD 21014

The Maryland Historic Sites Inventory was officially created by an Act of the Maryland Legislature, to be found in the Annotated Code of Maryland, Article 41, Section 181 KA, 1974 Supplement.

The Survey and Inventory are being prepared for information and record purposes only and do not constitute any infringement of individual property rights.

RETURN TO: Maryland Historical Trust  
The Shaw House, 21 State Circle  
Annapolis, Maryland 21401  
(301) 267-1438

NATIONAL REGISTER OF HISTORIC PLACES  
INVENTORY - NOMINATION FORM

(Type all entries - complete applicable sections)

STATE: \_\_\_\_\_

COUNTY: \_\_\_\_\_

FOR NPS USE ONLY

ENTRY NUMBER	DATE

1. NAME

COMMON: *Clark's Methodist Church*

AND/OR HISTORIC: \_\_\_\_\_

2. LOCATION

STREET AND NUMBER: *East side of Kalmia Road about 0.2 mi south of Forge Hill Road.*

CITY OR TOWN: *Kalmia*

STATE: *Maryland* CODE \_\_\_\_\_ COUNTY: *Harford* CODE \_\_\_\_\_

3. CLASSIFICATION

CATEGORY (Check One)	OWNERSHIP	STATUS	ACCESSIBLE TO THE PUBLIC
District <input type="checkbox"/> Building <input checked="" type="checkbox"/> Site <input type="checkbox"/> Structure <input type="checkbox"/> Object <input type="checkbox"/>	Public <input type="checkbox"/> Private <input type="checkbox"/> <i>Both</i> <input checked="" type="checkbox"/>	Public Acquisition: <input type="checkbox"/> In Process <input type="checkbox"/> Being Considered <input type="checkbox"/>	Occupied <input checked="" type="checkbox"/> Yes: <input type="checkbox"/> Restricted <input type="checkbox"/> Unoccupied <input type="checkbox"/> Preservation work in progress <input type="checkbox"/> No: <input type="checkbox"/>

PRESENT USE (Check One or More as Appropriate)

Agricultural <input type="checkbox"/>	Government <input type="checkbox"/>	Park <input type="checkbox"/>	Transportation <input type="checkbox"/>	Comments <input type="checkbox"/>
Commercial <input type="checkbox"/>	Industrial <input type="checkbox"/>	Private Residence <input type="checkbox"/>	Other (Specify) <input type="checkbox"/>	_____
Educational <input type="checkbox"/>	Military <input type="checkbox"/>	Religious <input checked="" type="checkbox"/>	_____	_____
Entertainment <input type="checkbox"/>	Museum <input type="checkbox"/>	Scientific <input type="checkbox"/>	_____	_____

4. OWNER OF PROPERTY

OWNERS NAME: *Trustees of the Clark Methodist Church*

STREET AND NUMBER: *Kalmia Road and Old Forge Road*

CITY OR TOWN: *Bel Air* STATE: *Maryland* CODE \_\_\_\_\_

5. LOCATION OF LEGAL DESCRIPTION

COURTHOUSE, REGISTRY OF DEEDS, ETC.: *Clark of Circuit Court*

STREET AND NUMBER: *Harford County Courthouse 40 S. Main St*

CITY OR TOWN: *Bel Air* STATE: *Maryland* CODE \_\_\_\_\_

APPROXIMATE ACREAGE OF NOMINATED PROPERTY: \_\_\_\_\_

6. REPRESENTATION IN EXISTING SURVEYS

TITLE OF SURVEY: \_\_\_\_\_

DATE OF SURVEY: \_\_\_\_\_ Federal ☐ State ☐ County ☐ Local ☐

DEPOSITORY FOR SURVEY RECORDS: \_\_\_\_\_

STREET AND NUMBER: \_\_\_\_\_

CITY OR TOWN: \_\_\_\_\_ STATE: \_\_\_\_\_ CODE \_\_\_\_\_

SEE INSTRUCTIONS

Color: 6884

FOR NPS USE ONLY  
ENTRY NUMBER  
DATE

## 7. DESCRIPTION

CONDITION	(Check One)					
	Excellent <input type="checkbox"/>	Good <input type="checkbox"/>	Fair <input type="checkbox"/>	Deteriorated <input checked="" type="checkbox"/>	Ruins <input type="checkbox"/>	Unexposed <input type="checkbox"/>
INTEGRITY	(Check One)			(Check One)		
	Altered <input type="checkbox"/>	Unaltered <input checked="" type="checkbox"/>		Moved <input type="checkbox"/>	Original Site <input checked="" type="checkbox"/>	

DESCRIBE THE PRESENT AND ORIGINAL (If known) PHYSICAL APPEARANCE

This stuccoed stone church, ~~two~~  
 2 bays by 3, faces south, the ridge  
 line running north-south.

Windows 1/1 are pointed  
 with new plaster filling the corners\*

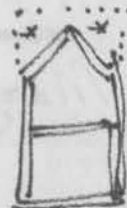

One small cedar block chimney - no  
 bell tower, 2 air conditioners, grounds  
 unkempt.

SEE INSTRUCTIONS



## B. SIGNIFICANCE

PERIOD (Check One or More as Appropriate)

Pre-Columbian ☐16th Century ☐18th Century ☐20th Century ☐15th Century ☐17th Century ☐19th Century ☒

SPECIFIC DATE(S) (If Applicable and Known)

1878

AREAS OF SIGNIFICANCE (Check One or More as Appropriate)

Aboriginal ☐Education ☐Political ☐Urban Planning ☐Prehistoric ☐Engineering ☐

Religion/Phi-

Other (Specify) ☐Historic ☐Industry ☐losophy ☐Agriculture ☐Invention ☐Science ☐Art ☐Landscape ☐Sculpture ☐Commerce ☐Architecture ☐

Social/Human-

Communications ☐Literature ☐itarian ☒Conservation ☐Military ☐Theater ☐Music ☐Transportation ☐

historic -

STATEMENT OF SIGNIFICANCE (Include Personages, Dates, Events, Etc.)

This small church is pastored by  
a minister who lives in Baltimore and  
tends three churches, Reverend James Smith.

This church ~~built~~ serves a congregation area  
from Bel Air, Dublin, Darlington and  
Churchville, and has been in constant  
use since it was built for the negro  
community at Kalmia in ~~1878~~ 1878.

(Once a community of farm laborers or  
workers at the Forge nearby, it is now  
supported by jobs in Bel Air stores, households  
or in the Bata Shoe factory at Belcamp.)

SEE INSTRUCTIONS

## 9. MAJOR BIBLIOGRAPHICAL REFERENCES

Report by Mrs Frieda Barnes (Mrs Charles W.)  
 ————— Kalmia Road, Bel Air RFD  
 Telephone 838 8038

## 10. GEOGRAPHICAL DATA

LATITUDE AND LONGITUDE COORDINATES DEFINING A RECTANGLE LOCATING THE PROPERTY				O R	LATITUDE AND LONGITUDE COORDINATES DEFINING THE CENTER POINT OF A PROPERTY OF LESS THAN ONE ACRE			
CORNER	LATITUDE				LONGITUDE			
	Degrees	Minutes	Seconds		Degrees	Minutes	Seconds	
NW	°	'	"		°	'	"	
NE	°	'	"		°	'	"	
SE	°	'	"		°	'	"	
SW	°	'	"		°	'	"	

LIST ALL STATES AND COUNTIES FOR PROPERTIES OVERLAPPING STATE OR COUNTY BOUNDARIES

STATE:	CODE	COUNTY	CODE
STATE:	CODE	COUNTY:	CODE
STATE:	CODE	COUNTY:	CODE
STATE:	CODE	COUNTY:	CODE

## 11. FORM PREPARED BY

NAME AND TITLE: <i>BSewer</i>	
ORGANIZATION: <i>AAHT Maryland Historic Trust</i>	DATE: <i>Nov 69</i>
STREET AND NUMBER: <i>50 State Circle</i>	
CITY OR TOWN: <i>Annapolis</i>	STATE: <i>Maryland</i> CODE: <i></i>

## 12. STATE LIAISON OFFICER CERTIFICATION

## NATIONAL REGISTER VERIFICATION

As the designated State Liaison Officer for the National Historic Preservation Act of 1966 (Public Law 89-665), I hereby nominate this property for inclusion in the National Register and certify that it has been evaluated according to the criteria and procedures set forth by the National Park Service. The recommended level of significance of this nomination is:

National ☐ State ☐ Local ☐

Name \_\_\_\_\_

Title \_\_\_\_\_

Date \_\_\_\_\_

I hereby certify that this property is included in the National Register.

\_\_\_\_\_  
 Chief, Office of Archeology and Historic Preservation

Date \_\_\_\_\_

ATTEST:

\_\_\_\_\_  
 Keeper of The National Register

Date \_\_\_\_\_

SEE INSTRUCTIONS



HA-48  
Clark's Chapel M.E. Church  
Jennings & Herrick,  
Map of Harford County,  
1858

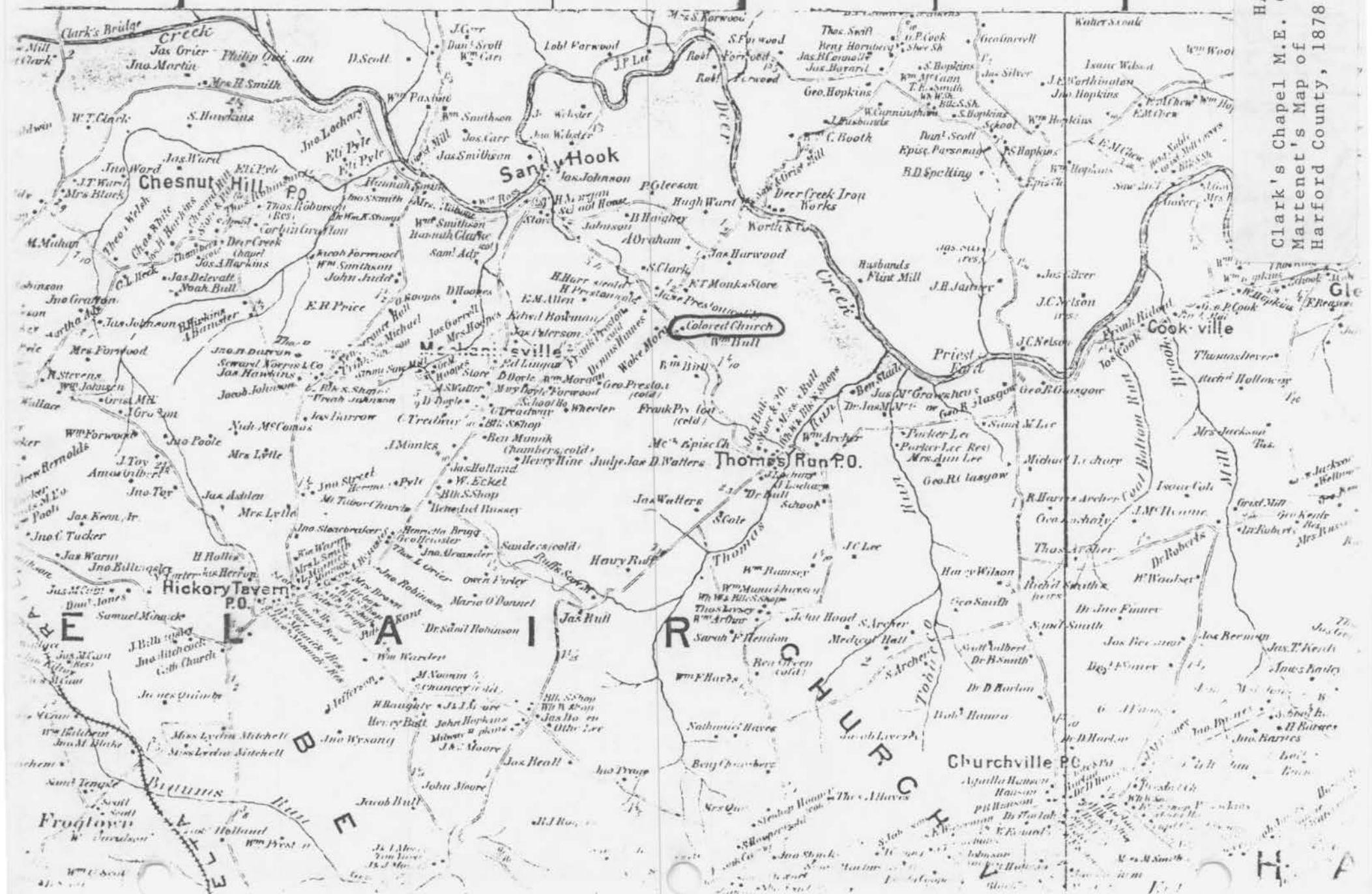







Clark's Chapel M. E. Church      HA-48  
Harford County  
Photo: Janet Davis  
October 1982  
South elevation